

# VPC13-C33-G1

# VPC15-C53-G1

## Chromebox Slot-in PC

## User Guide

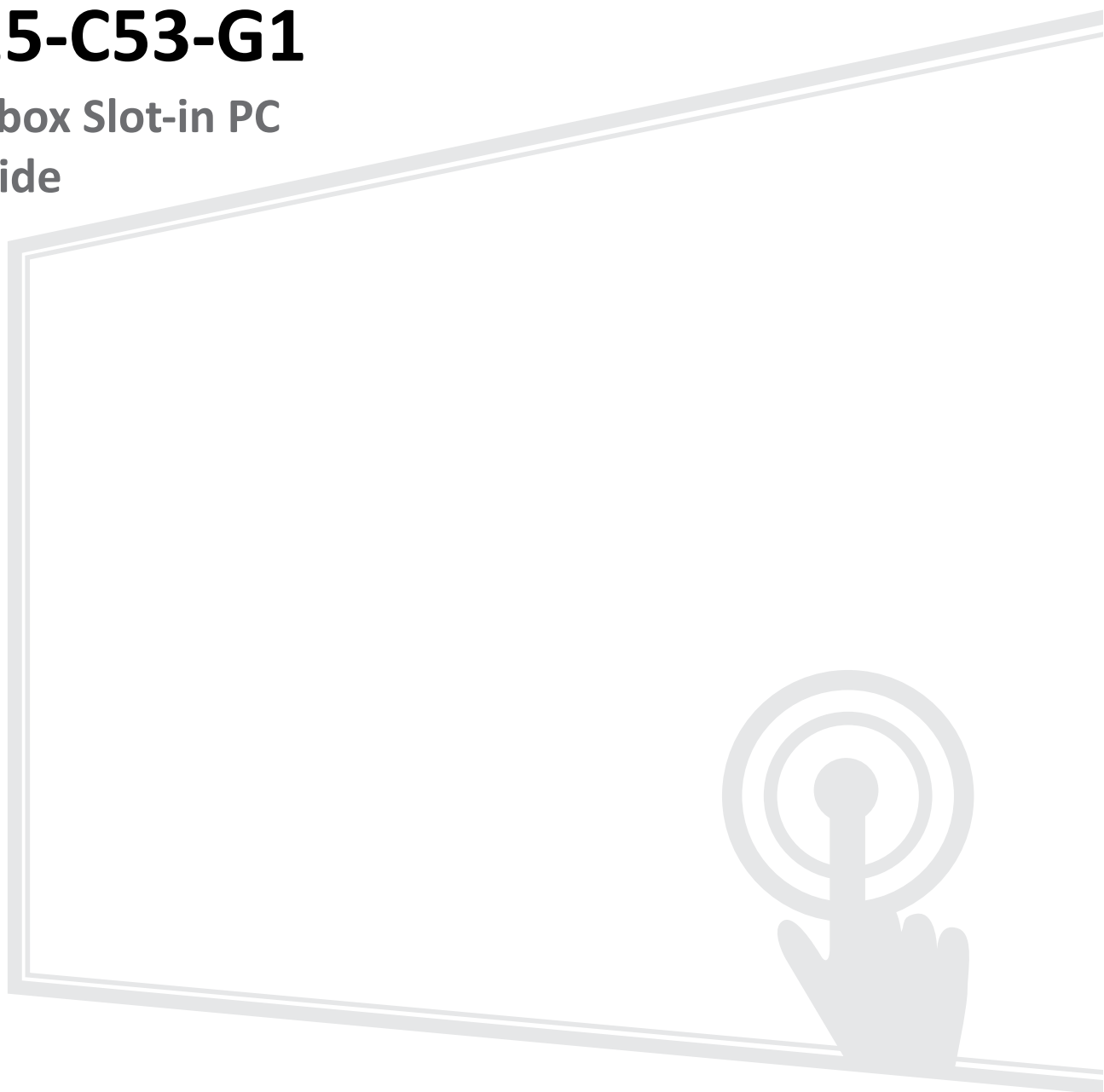

IMPORTANT: Please read this User Guide to obtain important information on installing and using your product in a safe manner, as well as registering your product for future service. Warranty information contained in this User Guide will describe your limited coverage from ViewSonic® Corporation, which is also found on our web site at <http://www.viewsonic.com> in English, or in specific languages using the Regional selection box of our website.

## **Thank you for choosing ViewSonic®**

As a world-leading provider of visual solutions, ViewSonic® is dedicated to exceeding the world's expectations for technological evolution, innovation, and simplicity. At ViewSonic®, we believe that our products have the potential to make a positive impact in the world, and we are confident that the ViewSonic® product you have chosen will serve you well.

Once again, thank you for choosing ViewSonic®!

# Contents

<b>Introduction .....</b>	<b>4</b>
Rear View.....	4
<b>Initial Setup.....</b>	<b>5</b>
Installing the Chromebox .....	5
<b>Making Connections.....</b>	<b>6</b>
Network Connection.....	6
USB Connection .....	6
<b>Using the Device.....</b>	<b>7</b>
Selecting an Input Source .....	7
IFP Series .....	7
CDE Series.....	8
<b>Appendix.....</b>	<b>9</b>
General Specifications .....	9
Antenna Information .....	10
<b>Regulatory and Service Information .....</b>	<b>11</b>
Compliance Information.....	11
FCC Compliance Statement.....	11
FCC Radiation Exposure Statement.....	11
Industry Canada Statement.....	12
Restrictions in the 5 GHz Band .....	12
Restrictions Dans la Bande de 5 GHz.....	12
Country Code Statement.....	13
IC Radiation Exposure Statement.....	13
CE Conformity for European Countries .....	14
Declaration of RoHS2 Compliance.....	16
Indian Restriction of Hazardous Substances .....	17
Product Disposal at End of Product Life .....	17
Copyright Information .....	18
Customer Service .....	19

# Introduction

## Rear View

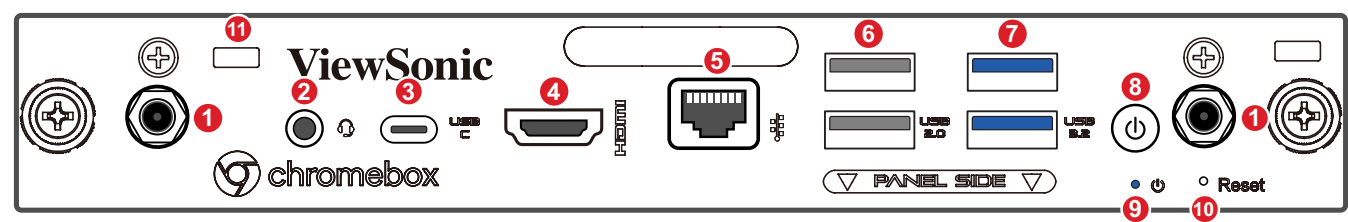

Number	Item	Description						
1	Antenna	Wi-Fi antenna interface.						
2	LINE-Out	Audio out for connected headphones or microphones.						
3	USB C	USB 3.2 port; Type-C interface.						
4	HDMI	Extend content out to another display device.						
5	LAN	Standard RJ45 (10M/100M/1G) internet connection port. <b>NOTE:</b> This network port is only used for PC.						
6	USB 2.0	USB 2.0 port.						
7	USB 3.2	USB 3.2 Gen 1 port.						
8	Power Button	Turn the slot-in PC on or off.						
9	Power LED	Power indicator light (Blue).						
		<table><tr><th>Mode</th><th>Description</th></tr><tr><td>Off</td><td>Indicator light is off.</td></tr><tr><td>On</td><td>Blue indicator light is always on.</td></tr></table>	Mode	Description	Off	Indicator light is off.	On	Blue indicator light is always on.
		Mode	Description					
		Off	Indicator light is off.					
On	Blue indicator light is always on.							
10	Reset	Reset button.						
11	Security Lock	Anti-theft security lock.						

# Initial Setup

## Installing the Chromebox

1. Remove the slot-in PC cover of the display.

**NOTE:** Some IFP models may not have the slot-in PC cover.

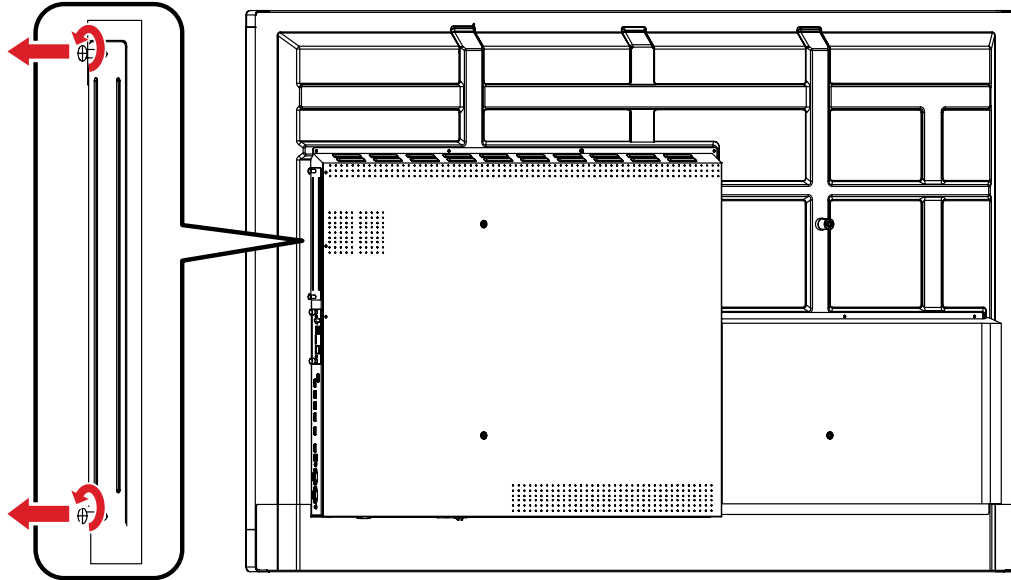

2. Using the handle of the Chromebox, carefully insert it into the PC slot of the display.

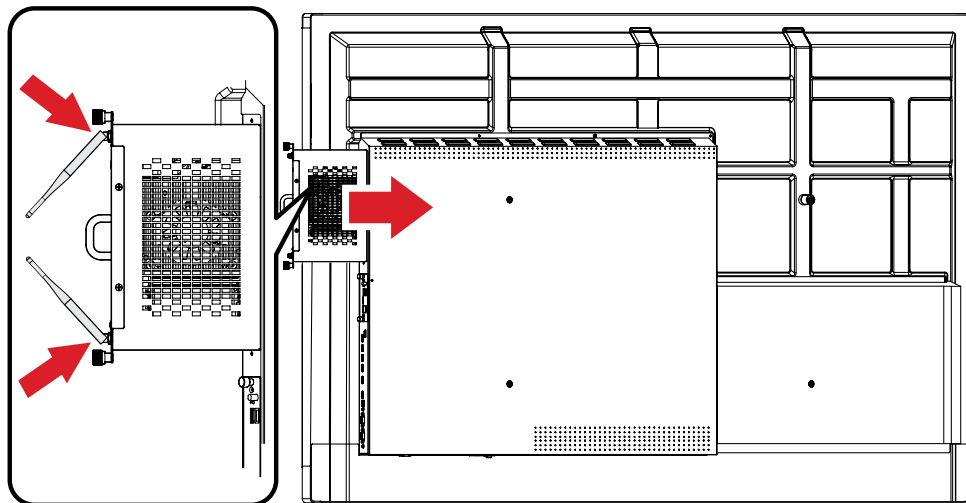

3. Secure the Chromebox to the display with the two included screws.

**NOTE:**

- Please note that the antennas must be installed on the Chromebox.
- Please pay attention to the installation direction of the Chromebox, with the vents facing outwards to avoid damage.
- The Chromebox products do not support hot swapping. When removing or installing the device, turn off the power supply for both the display and the Chromebox first.

# Making Connections

## Network Connection

To connect to the Internet or a network, connect one end of a RJ45 cable to the **LAN** port of the Chromebox, then connect the other end to your network.

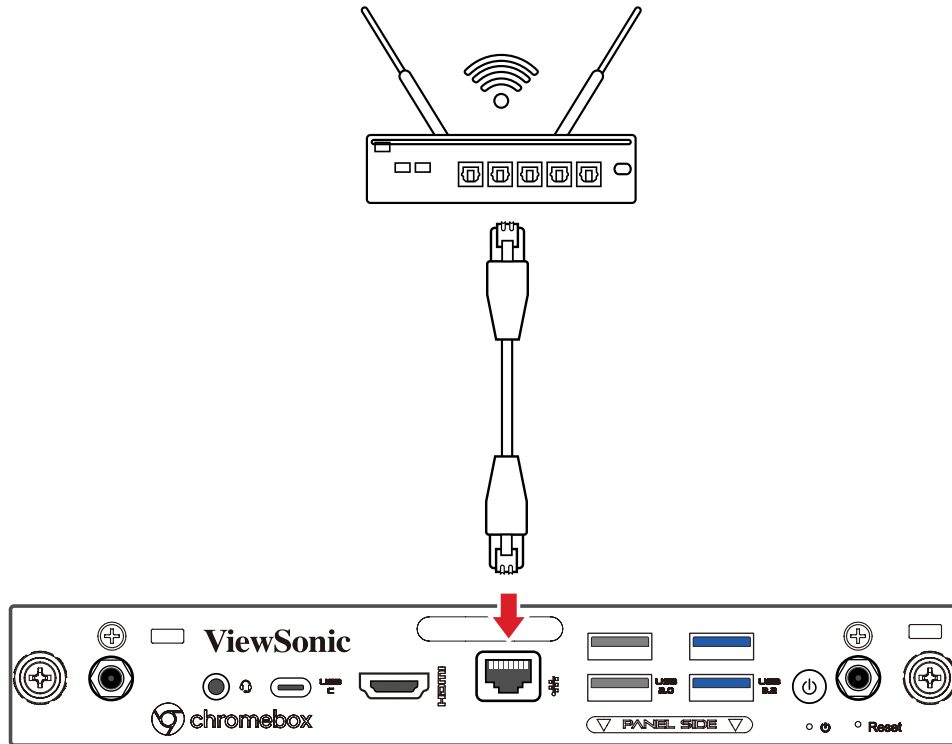

## USB Connection

USB peripherals such as keyboards, mice, storage devices, etc. can be connected to the Chromebox's **USB** ports.

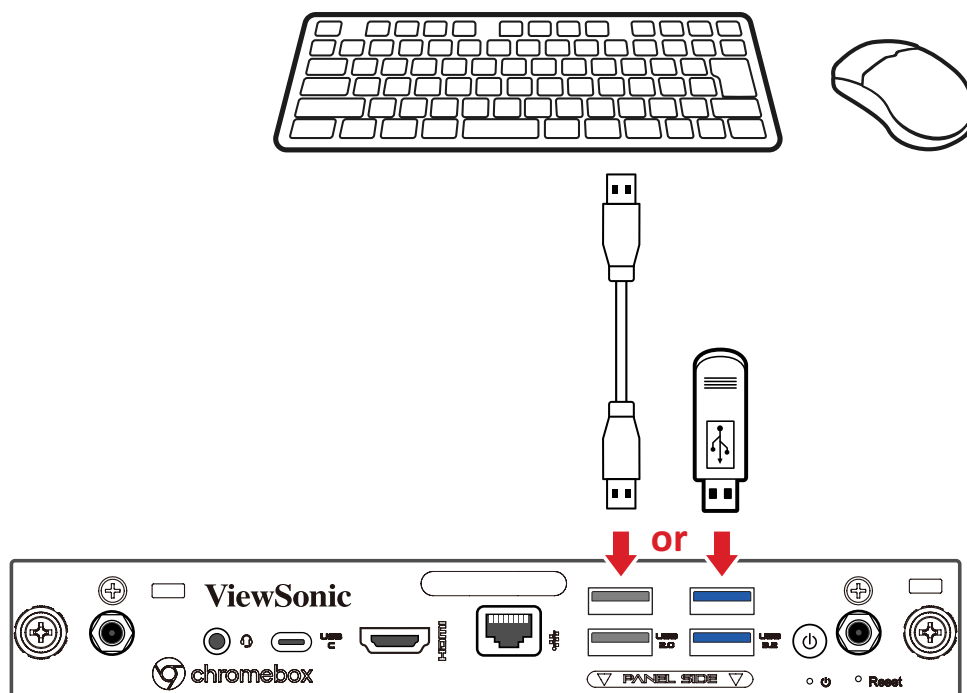

# Using the Device

## Selecting an Input Source

### IFP Series

To select an input source:

1. Tap the Settings icon from the toolbar to display the Input Source menu.

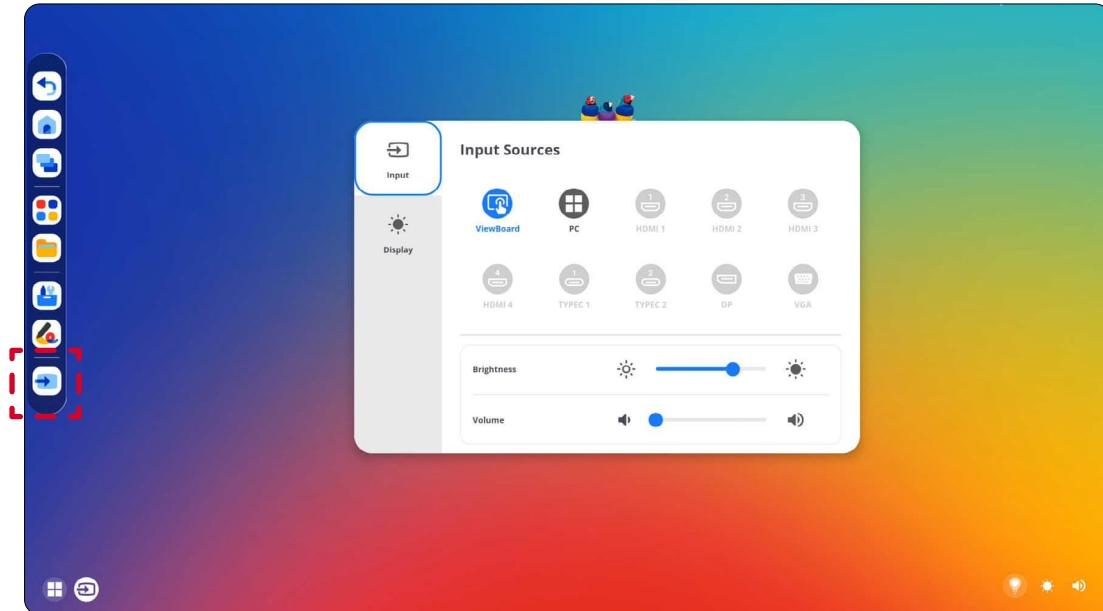

2. Tap the PC source.

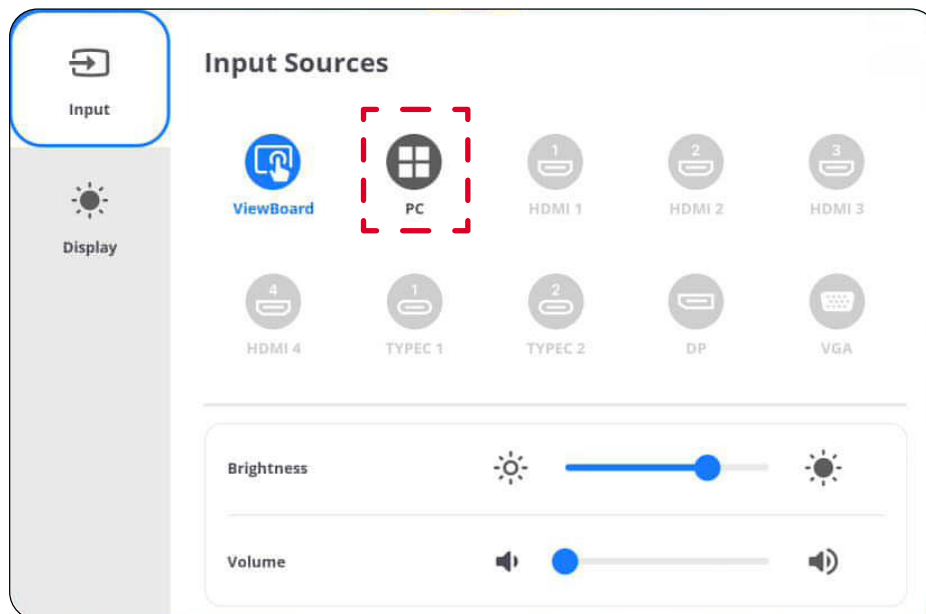



3. Tap a blank area outside of the menu to exit.

**NOTE:** Some IFP models may have a button on the side panel or remote control to open the Input Settings menu directly. Refer to your IFP user guide for more details.

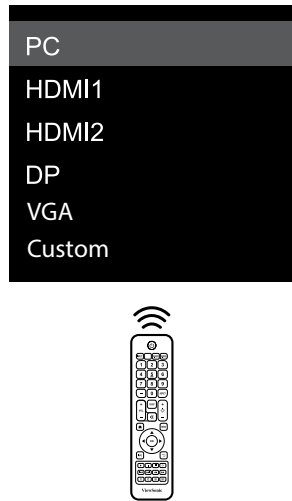
## CDE Series



To select an input source:

1. Press **INPUT**/ on the remote control.
2. Press **▼/▲** on the remote control to select the PC source.
3. Press **OK/ENTER** on the remote control.
4. Press **EPG/BACK**/ on the remote control to exit.

**NOTE:** The above image is for reference only and is subject to change without notice.



# Appendix

## General Specifications

Category	Item	Specifications
I/O	Ports	1 x HDMI out (Max: 3840 x 2160 @ 60 Hz)
		1 x RJ45 (LAN) (10M/100M/1G)
		2 x USB 2.0 (5V/0.5A)
		2 x USB 3.2 Gen. 1 (5V/0.9A)
		1 x USB Type C
		1 x Microphone/Headphone combo jack (3.5 mm)
		2 x Antenna jacks (2.4G/5G dual bands)
Physical	Dimensions (W x H x D)	200 x 118 x 30 mm
		7.87" x 4.64" x 1.18"
	Weight	0.70 kg
		1.54 lb
Operating Conditions	Relative Humidity	40°C/93% RH for 48 hours
	Temperature	0°C ~ 40°C
		32°F ~ 104°F
Storage/Shipping Conditions	Relative Humidity	0% ~ 95% (non-condensing)
	Temperature	-20°C ~ 60°C
		-4°F ~ 140°F
Power	Voltage	12~19V DC
	Consumption	90W (Maximum)
Wi-Fi Module	Form Factor	Wi-Fi 6E
		Bluetooth 5.2 Garfield Peak 2 non-vPro
	Frequency Range and Output Power (Max.)	<u>BT</u> • 2.400 GHz~2.4835 GHz (< 20dBm)
		<u>Wi-Fi</u> • 2.402 GHz~2.482 GHz (< 20dBm) • 5.150 GHz~5.885 GHz (< 20dBm) • 5.925 GHz~7.125 GHz (< 20dBm)

## Antenna Information

Category	Specifications		
Antenna Type	Dipole		
Manufacturer	INPAQ TECHNOLOGY		
Model Name	DAM-L14-B4-N0-000-04-02		
Antenna Gain	2400~2483.5MHz: 1.49 (dBi)		
	5150~5250 MHz: 2.91 (dBi)		
	5250~5350 MHz: 2.06 (dBi)		
	5470~5725 MHz: 1.59 (dBi)		
	5725~5850 MHz: 2.81 (dBi)		
	5945~6425 MHz: 1.73 (dBi)		
Frequency Range and Output Power (Max.)	Bluetooth/BLE	2400~2483.5 MHz	10 dBm
	IEEE 802.11b/g/n/ax	2400~2483.5 MHz	2400~2483.5 MHz
	IEEE 802.11a/n/ac/ax	5150~5350 MHz	23 dBm
		5470~5725 MHz	
		5725~5850 MHz	14 dBm
	IEEE 802.11ax	5945~6425 MHz	23 dBm (LPI)
			14 dBm (VLP)
Connector Type	IPEX MHF4 to RP-SMA		

# Regulatory and Service Information

## Compliance Information

This section addresses all connected requirements and statements regarding regulations. Confirmed corresponding applications shall refer to nameplate labels and relevant markings on the unit.

### FCC Compliance Statement

FCC ID: PD9AX211NG

This device complies with part 15 of FCC Rules. Operation is subject to the following two conditions: (1) this device may not cause harmful interference, and (2) this device must accept any interference received, including interference that may cause undesired operation. This equipment has been tested and found to comply with the limits for a Class B digital device, pursuant to part 15 of the FCC Rules.

These limits are designed to provide reasonable protection against harmful interference in a residential installation. This equipment generates, uses, and can radiate radio frequency energy, and if not installed and used in accordance with the instructions, may cause harmful interference to radio communications. However, there is no guarantee that interference will not occur in a particular installation. If this equipment does cause harmful interference to radio or television reception, which can be determined by turning the equipment off and on, the user is encouraged to try to correct the interference by one or more of the following measures:

- Reorient or relocate the receiving antenna.
- Increase the separation between the equipment and receiver.
- Connect the equipment into an outlet on a circuit different from that to which the receiver is connected.
- Consult the dealer or an experienced radio/TV technician for help.

### FCC Radiation Exposure Statement

This device complies with FCC: radiation exposure limits set forth for an uncontrolled environment. End users must follow the specific operating instructions for satisfying RF exposure compliance.

This transmitter must not be co-located or operating in conjunction with any other antenna or transmitter. This device should be installed and operated with a minimum distance of 20 centimeters between the radiator and your body.

The user manual or instruction manual for an intentional or unintentional radiator shall caution the user that changes or modifications not expressly approved by the Party responsible for compliance could void the user's authority to operate the equipment.

## **Industry Canada Statement**

IC ID: 1000M-AX211NG

CAN ICES (B) / NMB (B)

This Class B digital apparatus complies with Canadian ICES-003.

Cet appareil numérique de la classe B est conforme à la norme NMB-003 du Canada.

This device complies with Industry Canada license-exempt RSS standard(s):  
Operation is subject to the following Two conditions:(1) this device may not cause interference, and (2) this device must accept any interference, including interference that may cause undesired operation of the device.

Le présent appareil est conforme aux CNR d'Industrie Canada applicables aux appareils radio exempts de licence. L'exploitation est autorisée aux deux conditions suivantes : (1) l'appareil ne doit pas produire de brouillage, et (2) l'utilisateur de l'appareil doit accepter tout brouillage radioélectrique subi, même si le brouillage est susceptible d'en compromettre le fonctionnement.

### **Restrictions in the 5 GHz Band**

Within the 5.15 to 5.25 GHz band, UNII devices will be restricted to indoor operations to reduce any potential for harmful interference to co-channel Mobile Satellite System (MSS) operations.

### **Restrictions Dans la Bande de 5 GHz**

Dans la bande de 5,15 à 5,25 GHz, les appareils UNII seront restreints aux opérations intérieures pour réduire toute possibilité d'interférence pouvant nuire aux opérations du Système satellite mobile dans le même canal(MSS).

This radio transmitter [1000M-AX211NG] has been approved by Innovation, Science and Economic Development Canada to operate with the antenna types listed below, with the maximum Permissible gain indicated. Antenna types not included in this list that have a gain greater than the maximum gain indicated for any type listed are strictly prohibited for use with this device.

— Le présent émetteur radio [1000M-AX211NG] a été approuvé par Innovation, Sciences et Développement économique Canada pour fonctionner avec les types d'antenne énumérés cidessous et ayant un gain admissible maximal. Les types d'antenne non inclus dans cette liste, et dont le gain est supérieur au gain maximal indiqué pour.

## **Country Code Statement**

For product available in the USA/Canada market, only channel 1~11 can be operated. Selection of other channels is not possible.

Pour les produits disponibles aux États-Unis/Canada du marché, seul le canal 1 à 11 peuvent être exploités. Sélection d'autres canaux n'est pas possible.

## **IC Radiation Exposure Statement**

This device complied with IC RSS-102 radiation exposure limits set forth for an uncontrolled environment. This device should be installed and operated with minimum distance 20cm between the radiator & your body. The device for the band 5150-5825 MHz is only for indoor usage to reduce potential for harmful interference to co-channel mobile satellite systems.

Cet équipement est conforme aux limites d'exposition aux rayonnements IC établies pour un environnement non contrôlé. Cet équipement doit être installé et utilisé avec un minimum de 20cm de distance entre la source de rayonnement et votre corps. Les dispositifs fonctionnant dans la bande 5150- 5825 MHz sont réservés uniquement pour une utilisation à l'intérieur afin de réduire les risques de brouillage.

## CE Conformity for European Countries



The device complies with the EMC Directive 2014/30/EU, Low Voltage Directive 2014/35/EU and Radio Equipment Directive 2014/53/EU.

[https://www.viewsonicglobal.com/public/products\\_download/safety\\_compliance/acc/VS20584\\_CE\\_DoC.pdf](https://www.viewsonicglobal.com/public/products_download/safety_compliance/acc/VS20584_CE_DoC.pdf)

### The following information is only for EU-member states:

The mark shown to the right is in compliance with the Waste Electrical and Electronic Equipment Directive 2012/19/EU (WEEE). The mark indicates the requirement NOT to dispose of the equipment as unsorted municipal waste, but use the return and collection systems according to local law.



Batteries may not be disposed in trash or household recycling collection bins intended to receive other non-hazardous waste and/or recyclable materials. Please use the public collection system to return, recycle, or treat them in compliance with the local regulations. This product may contain button batteries, please keep it away from children.

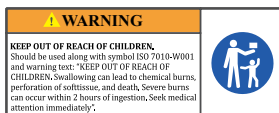

These devices comply with RF specifications when the device is used at 20 cm from your body.

Operation in the band 5150-5250 MHz is only for indoor use to reduce the potential for harmful interference to co-channel mobile satellite systems.

La bande 5150-5250 MHz est réservés uniquement pour une utilisation à l'intérieur afin de réduire les risques de brouillage préjudiciable aux systèmes de satellites mobiles utilisant les mêmes canaux.

	BE	BG	CZ	DK	DE	EE	IE
	EL	ES	FR	HR	IT	CY	LV
	LT	LU	HU	MT	NL	AT	PL
	PT	RO	SI	SK	FI	SE	NO
	IS	LI	CH	TR	UK(NI)		

## Declaration of RoHS2 Compliance

This product has been designed and manufactured in compliance with Directive 2011/65/EU of the European Parliament and the Council on restriction of the use of certain hazardous substances in electrical and electronic equipment (RoHS2 Directive) and is deemed to comply with the maximum concentration values issued by the European Technical Adaptation Committee (TAC) as shown below:

Substance	Proposed Maximum Concentration	Actual Concentration
Lead (Pb)	0.1%	< 0.1%
Mercury (Hg)	0.1%	< 0.1%
Cadmium (Cd)	0.01%	< 0.01%
Hexavalent Chromium (Cr6 <sup>+</sup> )	0.1%	< 0.1%
Polybrominated biphenyls (PBB)	0.1%	< 0.1%
Polybrominated diphenyl ethers (PBDE)	0.1%	< 0.1%
Bis(2-ethylhexyl) phthalate (DEHP)	0.1%	< 0.1%
Butyl benzyl phthalate (BBP)	0.1%	< 0.1%
Dibutyl phthalate (DBP)	0.1%	< 0.1%
Diisobutyl phthalate (DIBP)	0.1%	< 0.1%

### Certain components of products as stated above are exempted under the Annex III of the RoHS2 Directives as noted below:

- Copper alloy containing up to 4% lead by weight.
- Lead in high melting temperature type solders (i.e. lead-based alloys containing 85% by weight or more lead).
- Electrical and electronic components containing lead in a glass or ceramic other than dielectric ceramic in capacitors, e.g. piezoelectronic devices, or in a glass or ceramic matrix compound.
- Lead in dielectric ceramic in capacitors for a rated voltage of 125V AC or 250V DC or higher.



## Indian Restriction of Hazardous Substances

Restriction on Hazardous Substances statement (India). This product complies with the “India E-waste Rule 2011” and prohibits use of lead, mercury, hexavalent chromium, polybrominated biphenyls or polybrominated diphenyl ethers in concentrations exceeding 0.1 weight % and 0.01 weight % for cadmium, except for the exemptions set in Schedule 2 of the Rule.

## Product Disposal at End of Product Life

ViewSonic® respects the environment and is committed to working and living green. Thank you for being part of Smarter, Greener Computing. Please visit the ViewSonic® website to learn more.

### USA & Canada:

<https://www.viewsonic.com/us/go-green-with-viewsonic>

### Europe:

<https://www.viewsonic.com/eu/environmental-social-governance/recycle>

### Taiwan:

<https://recycle.moenv.gov.tw/>

**For EU users, please contact us for any safety/accident issue experienced with this product:**

ViewSonic Europe Limited



Haaksbergweg 75  
1101 BR Amsterdam  
Netherlands



+31 (0) 650608655



[EPREL@viewsoniceurope.com](mailto:EPREL@viewsoniceurope.com)



<https://www.viewsonic.com/eu/>

## Copyright Information

Copyright© ViewSonic® Corporation, 2025. All rights reserved.

Macintosh and Power Macintosh are registered trademarks of Apple Inc.

Microsoft, Windows, and the Windows logo are registered trademarks of Microsoft Corporation in the United States and other countries.

ViewSonic® and the three birds logo are registered trademarks of ViewSonic® Corporation.

VESA is a registered trademark of the Video Electronics Standards Association. DPMS, DisplayPort, and DDC are trademarks of VESA.

**Disclaimer:** ViewSonic® Corporation shall not be liable for technical or editorial errors or omissions contained herein; nor for incidental or consequential damages resulting from furnishing this material, or the performance or use of this product.

In the interest of continuing product improvement, ViewSonic® Corporation reserves the right to change product specifications without notice. Information in this document may change without notice.

No part of this document may be copied, reproduced, or transmitted by any means, for any purpose without prior written permission from ViewSonic® Corporation.

## Customer Service

For technical support or product service, see the table below or contact your reseller.

**NOTE:** You will need the product's serial number.

Country/ Region	Website	Country/ Region	Website
<b>Asia Pacific &amp; Africa</b>			
Australia	<a href="http://www.viewsonic.com/au/">www.viewsonic.com/au/</a>	Bangladesh	<a href="http://www.viewsonic.com/bd/">www.viewsonic.com/bd/</a>
中国 (China)	<a href="http://www.viewsonic.com.cn">www.viewsonic.com.cn</a>	香港 (繁體中文)	<a href="http://www.viewsonic.com/hk/">www.viewsonic.com/hk/</a>
Hong Kong (English)	<a href="http://www.viewsonic.com/hk-en/">www.viewsonic.com/hk-en/</a>	India	<a href="http://www.viewsonic.com/in/">www.viewsonic.com/in/</a>
Indonesia	<a href="http://www.viewsonic.com/id/">www.viewsonic.com/id/</a>	Israel	<a href="http://www.viewsonic.com/il/">www.viewsonic.com/il/</a>
日本 (Japan)	<a href="http://www.viewsonic.com/jp/">www.viewsonic.com/jp/</a>	Korea	<a href="http://www.viewsonic.com/kr/">www.viewsonic.com/kr/</a>
Malaysia	<a href="http://www.viewsonic.com/my/">www.viewsonic.com/my/</a>	Middle East	<a href="http://www.viewsonic.com/me/">www.viewsonic.com/me/</a>
Myanmar	<a href="http://www.viewsonic.com/mm/">www.viewsonic.com/mm/</a>	Nepal	<a href="http://www.viewsonic.com/np/">www.viewsonic.com/np/</a>
New Zealand	<a href="http://www.viewsonic.com/nz/">www.viewsonic.com/nz/</a>	Pakistan	<a href="http://www.viewsonic.com/pk/">www.viewsonic.com/pk/</a>
Philippines	<a href="http://www.viewsonic.com/ph/">www.viewsonic.com/ph/</a>	Singapore	<a href="http://www.viewsonic.com/sg/">www.viewsonic.com/sg/</a>
臺灣 (Taiwan)	<a href="http://www.viewsonic.com/tw/">www.viewsonic.com/tw/</a>	ประเทศไทย	<a href="http://www.viewsonic.com/th/">www.viewsonic.com/th/</a>
Việt Nam	<a href="http://www.viewsonic.com/vn/">www.viewsonic.com/vn/</a>	South Africa & Mauritius	<a href="http://www.viewsonic.com/za/">www.viewsonic.com/za/</a>
<b>Americas</b>			
United States	<a href="http://www.viewsonic.com/us">www.viewsonic.com/us</a>	Canada	<a href="http://www.viewsonic.com/us">www.viewsonic.com/us</a>
Latin America	<a href="http://www.viewsonic.com/la">www.viewsonic.com/la</a>		
<b>Europe</b>			
Europe	<a href="http://www.viewsonic.com/eu/">www.viewsonic.com/eu/</a>	France	<a href="http://www.viewsonic.com/fr/">www.viewsonic.com/fr/</a>
Deutschland	<a href="http://www.viewsonic.com/de/">www.viewsonic.com/de/</a>	Қазақстан	<a href="http://www.viewsonic.com/kz/">www.viewsonic.com/kz/</a>
Россия	<a href="http://www.viewsonic.com/ru/">www.viewsonic.com/ru/</a>	España	<a href="http://www.viewsonic.com/es/">www.viewsonic.com/es/</a>
Türkiye	<a href="http://www.viewsonic.com/tr/">www.viewsonic.com/tr/</a>	Україна	<a href="http://www.viewsonic.com/ua/">www.viewsonic.com/ua/</a>
United Kingdom	<a href="http://www.viewsonic.com/uk/">www.viewsonic.com/uk/</a>		



**ViewSonic®**